

TWA065

| REV. | DESCRIPTION  | DATE    | ENG | ECO # | APPR |
|------|--|---------|-----|-------|------|
| 1    | CREATE DRAWING                                       | 25FEB08 | PP  |       | MB   |
| 2    | FAN PART NUMBER TO EF                                | 05MAR08 | PP  |       | MB   |
| 3    | CHANGE FAN MOUNT ITEM 3, ADD ITEM2                   | 14MAR08 | PP  |       | MB   |
| 4    | FILENAME WAS FAN. . . ; NOW TW703 (MATCHES PDF SPEC) | 15MAY08 | LR  |       |      |

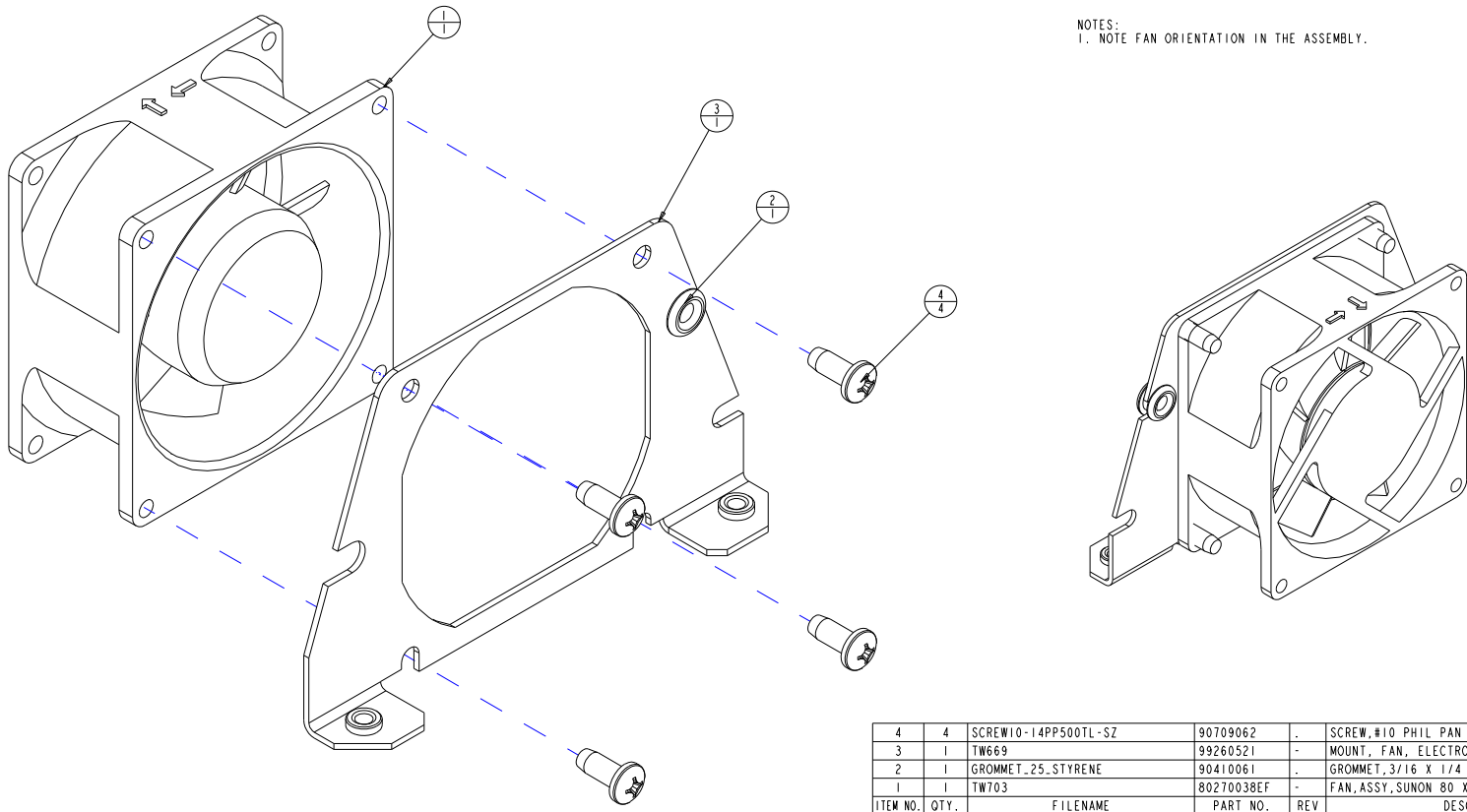

NOTES:  
1. NOTE FAN ORIENTATION IN THE ASSEMBLY.

| ITEM NO. | QTY. | FILENAME             | PART NO.   | REV | DESCRIPTION                               |
|----------|------|----------------------|------------|-----|---|
| 4        | 4    | SCREW10-14PP500TL-SZ | 90709062   | -   | SCREW, #10 PHIL PAN 1/2 PLASTITE SZ       |
| 3        | 1    | TW669                | 99260521   | -   | MOUNT, FAN, ELECTRONIC ENCLOSURE, SHOWGUN |
| 2        | 1    | GROMMET.25.STYRENE   | 90410061   | -   | GROMMET, 3/16 X 1/4 STYRENE BUTADIENE     |
| 1        | 1    | TW703                | 80270038EF | -   | FAN, ASSY, SUNON 80 X80 X38MM 74.5 CFM    |

|                               |  |                               |                    |  |  |
|-------------------------------|--|-------------------------------|--------------------|--|--|
| UNLESS OTHERWISE SPECIFIED    |  | RELEASE DATE:                 | CE:                | 2105 GRACY FARMS LANE<br>AUSTIN, TEXAS 78758<br>(512) 836-2242<br>FAX (512) 832-4128<br>***** http://www.highend.com |  |
| DIMENSIONAL TOLERANCES:       |  | ENG: MIKE BELL                | OA:                |  |  |
| 0 PLACE DECIMAL = ±0.38       |  | ME:                           | DRW: PETE PHILLIPS |  |  |
| 1 PLACE DECIMAL = ±0.25       |  | MEG:                          |                    |  |  |
| 2 PLACE DECIMALS = ±0.13      |  | DESCRIPTION:                  |                    | FINISH:  |  |
| ANGLES = ±0.5°                |  | FAN ASSEMBLY, EXHAUST         |                    | NA   |  |
| FOR PAINTED PARTS REFER TO    |  | MATERIAL:                     |                    | PART NO.   |  |
| ENG. SPEC. MANUAL WI-0582     |  | CHARTED                       |                    | INTERNAL   |  |
| ALL COMPONENTS, MATERIALS AND |  | FINISHES TO BE R6HS COMPLIANT |                    | DRAWING NO.  |  |
| MIN. DRAFT                    |  | INTERPRET DIMENSIONS PER      |                    | TWA065   |  |
| MIN. RADIUS                   |  | ASME Y14.5M-1994              |                    | REV.   |  |
| FLATNESS                      |  | THIRD ANGLE PROJECTION        |                    | 4  |  |
| THICKNESS                     |  | DIMENSIONS ARE IN MILLIMETERS |                    | DO NOT SCALE   |  |
| VOLUME                        |  | SCALE: 1:1000                 |                    | SHEET: 1 OF 1  |  |

PROPRIETARY NOTICE: THIS DOCUMENT CONTAINS CONFIDENTIAL AND PROPRIETARY INFORMATION OF HIGH END SYSTEMS INC., (ALSO DBA LIGHTWAVE RESEARCH) AND IS GIVEN TO THE RECEIVER IN CONFIDENCE. THE RECEIVER ACCEPTS AND AGREES THAT, EXCEPT AS AUTHORIZED BY HIGH END SYSTEMS, THE RECEIVER WILL NOT PERMIT THE USE OF THE DOCUMENT OR ANY COPY THEREOF OR THE INFORMATION THEREIN, WILL NOT COPY OR PERMIT COPYING THE DOCUMENT OR THE INFORMATION THEREIN, AND WILL UPON COMPLETION OF THE NEED TO RETURN THE DOCUMENT, OR UPON DEMAND, RETURN THE DOCUMENT WITHOUT RETAINING ANY OF THE INFORMATION CONTAINED THEREIN IN ANY FORM WHATSOEVER.